

Basement Plan - Proposed (Amended)  
1 : 200

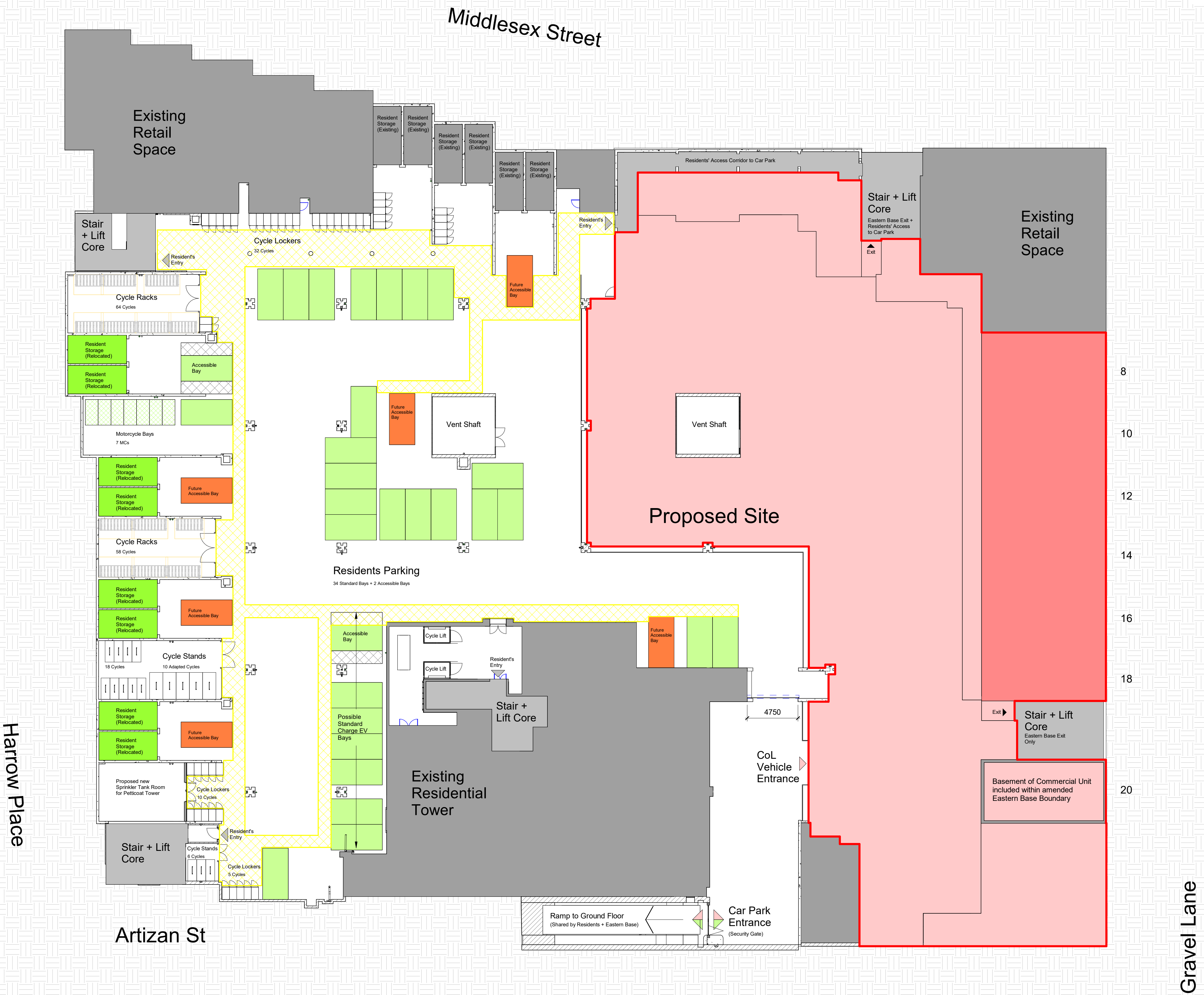
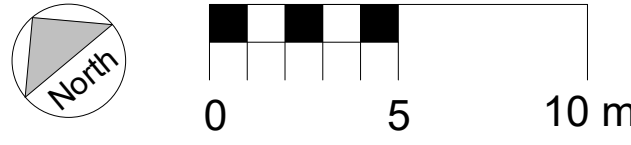

- Key**
- Existing Middlesex Street Estate Buildings
  - Existing Middlesex Street Estate Stair + Lift Cores
  - Existing Shops converted into new Offices + Support Facilities
  - Existing Car Park/Service Areas converted into new Car Parking + Support Facilities
  - New Commercial + Recycling Refuse Stores
  - Commercial Zone - New Parking Bays
  - Residents' Zone - New Parking Bays
  - Residents' Zone - Relocated Garage/ Store Areas

- Notes:**
- Indicative Parking Provision Shown:
- 34nr. Standard parking bays (Note: 6nr. of which could become Accessible Bays if required in the future)
  - 2nr. Accessible Bays
  - 7nr. Motorcycles
  - 203nr. Cycle Spaces comprising:
    - 122nr. semi vertical racks in secure cage
    - 18nr. stand spaces in secure cage
    - 10nr. larger bike stand spaces in secure cage
    - 53nr. secure cycle lockers
- Note: Existing cycle parking provision for whole site is currently 26nr. using 13nr. stands at Ground Floor*
- 14nr. Garages (subject to requirements)